

Picture 1

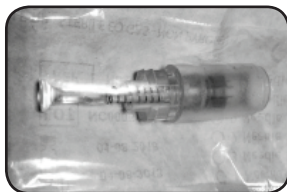

Picture 2



Picture 3

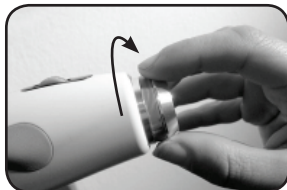

Picture 4

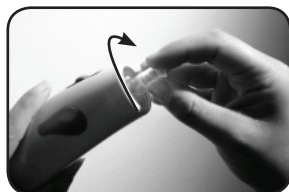

Picture 5

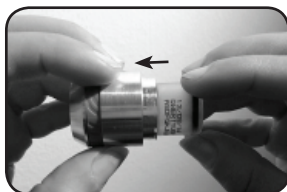

Picture 6

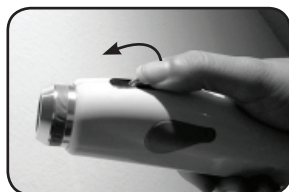

Picture 7



Picture 8



## DermaSense - User Manual



### *TRIPLE-ACTIVE Mesotherapy Device*



EU Authorized Representative

MedNet GmbH ,  
Borkstrasse 10, 48163 Muenster  
Germany

Manufacturer: **CoolSense Medical Ltd.**

149 Arlozorov st., Tel-Aviv 6299502, Israel

Please have the User Manual and Video Clip Available at Company's website

**WWW.COOLSENSE.NET**

All rights reserved to CoolSense Medical Ltd.

## DermaSense's Field of Operation - General Overview

The anti-aging skin rejuvenation **DermaSense™ Triple Active Device** provides unparalleled collagen induction via fragmented delivery of needles into the epidermis and dermis. These micro injuries to the skin encourages and harnesses the body's innate ability to re-grow and repair the skin through the physiology of collagen induction. **The DermaSense™'s** controlled precision allows for the three phases of CIT mechanics of new collagen growth to occur. The first phase begins with the release of the body's growth factors and the further cascade of new epidermal growth, fibroblast chemo-taxis, fibroblast proliferation and matrix production. This proliferation of body's tissue continues to release growth factors from fibroblasts, keratinocytes and monocytes culminating in the second phase of CIT mechanics where collagen III, IV and I, elastin, proteoglycans, GAG's and angiogenesis occur.

The last phase of CIT and the **DermaSense™** consists of tissue remodeling process where the skins vascular matrix matures and skin tightening as well as new collagen can be seen. The body's ability to remodel and heal itself is at the heart of this innovative product and because the process doesn't involve heat, thermal energy, chemicals or unnecessary trauma, the skin can heal quickly and with almost zero downtime.

**DermaSense™** can be use according to user's individual convenience.

The treatment is recommended to Face (not including eyes), Neck, Cleavage and Back of Hands.

*We thank you for choosing our DermSense and wish you an enjoyable and efficient usage. Our staff is available to support you with any problem or unclear one of our instructions.*

### Caution!

- Do not operate the **DermaSense™** until reading carefully the user manual's instructions.
- Make sure of the electric power input (AC 110-250V,50/60hz).
- Do not use this appliance near bathtubs, showers, basins or other vessels containing water.
- Do not use any unoriginal component (needle or ampule) while operating the device.
- Do not use any component (needle or ampule) which is not perfectly packed.
- The appliance shall not be used by persons with reduced physical, sensory or mental capabilities, or lack of experience and knowledge, unless they have been given supervision or instruction.
- Unauthorized to use the device are the following patients: User who has wound on the intended treatment skin's area, Skin's Cancer patients, Pregnant woman and Those who have metal allergy or skin disorders like dermatitis, active acne, etc.,.
- Avoid using the product for lips and eye-rims (especially eye-lids).
- Be aware:
  - \* Do not expose your skin to sunlight in the first 2 hours post treatment.
  - \* Keep your hands and the skin to be treated clean, while operating the device.
  - \* Those who have any doubt regarding their skin should consult their doctor.
  - \* Never use same needle head with 2 different people/patients.
  - \* Keep out of reach of children.
  - \* Do not disassemble or remodel this device.
  - \* Do not touch an adaptor and the power socket with wet hands while operation.
  - \* Never place the needle when the device switched on.
  - \* Do not use the device with children or animals.
  - \* Children shall be supervised not to play with the appliance.
  - \* Cleaning and user maintenance shall not be made by children without supervision.
  - \* In case of abnormal phenomenon (such as: eruption, inflammation, allergies) occurred please stop using the device and consult your doctor.

## “Operating the DermaSense” - Step by Step

1. Open the DermaSense package you have just purchased and verify the existence of the following components:
  - 1.1 Main DermaSense body device with Power Supply connected well directly and adjusted Metal Cooling Head (**Picture 1**). For the Pro version there are 2 additional reserve units.
  - 1.2 One Sterilized Needle package (**Picture 2**).
  - 1.3 One Ampule sealed with safety sticker (**Picture 3**)
2. Release the Cooling Head from the top of the device (**Picture 4**) and store it into your home freezer compartment.
3. When you are about to apply a treatment first wash the skin to be treated as well as your hands. Use alcohol to clean the operating area. Then, wash out with normal saline.
4. Then, open the sterilized needle package and adjust the Needle Head unit into its hose at the top of the device (**Picture 5**) by lightly pushing and swiveling the Needle Head clockwise.
5. Now, take out the metal Cooling Head from freezer compartment, take the Ampule out of its package (first take off the silver safety sticker from its surface) and adjust the Ampule deeply into Cooling Head unit's center (**Picture 6**). Previously, please verify that the pusher unit is located at its starting point by rolling back the Pusher Button (**Picture 7**).
6. **Important!** for home-user Version there is one step only with 0.5 mm depth. However, the Pro Version has 3 stages marked on the top of the device: 0.5 mm, 1.0 mm, 1.0 mm and 1.5 mm.
7. Plug in the power supply into the wall and start the application.
8. While moving along one or more of the recommended skin points, smear the Ampule content by scrolling down the pusher wheel located on top of device (**Picture 8**).
9. Do not force the DermaSense head with too many pressure, apply all over the face at about 4-5 times in vertical direction with gentle strength. Apply the same place with the same intensity to the level of the same area in horizontal direction, including the same direction. Apply on the skin area at least 4 to 5 times; continuously rolling until the entire face and neck have been treated around.  
Depending on your speed, accuracy and strength, if you are just treat the face and neck, about 10 minutes of treatment is enough. Tools should be careful to use above and below the eyelids. Bone side of the upper eyelid cannot be treated unless taut the bone side of the skin.
10. Treated skin should be in ventilated space for the coming 30 minutes without washing it or touched by water.
11. After accomplish any treatment – Professional and Home-User should dismantle the metal Cooling Head, wash it with soap and restore it for another 30 minutes before next use.
12. The Needle Head will be thrown to special insulated box in order to prevent future infections. Reuse of Needle Head by home-user is not recommended.
13. Empty Ampule should be taken off from the device head and be thrown to plastic part recycling container.
14. Take out the device plug from the wall and put the device back into its pouch until next operation.

### Product Specification

Name -	DermaSense Pro or DermaSense Home-User
Voltage -	110/220V 50/60hz, 12 w
Needles number -	9 needles
Needle length -	0.5-1.5 mm adjustable needle length (for Pro) 0.5 mm (for Home-User)
Needle material -	medical purpose stainless steel

DermaSense defined as Low Voltage electrical device and was approved by CE authorities and FDA under category of Low Voltage Electronic Device.

For maintenance and technical support, please contact your local representative published at our website **WWW.COOLSENSE.NET** or contact us directly through our website.

For customer service – please contact phone no. 972 3 64419005 or refer to customer service option by our website as mentioned above.